

---

# Heat Recovery Ventilator

## VL100EU5-E

---

## New VL100EU5



### New Feature (Tentative)

<b>Design change</b>	grill front -> <b>Flat panel design</b> ( Stylish like ZEN)
<b>New color</b>	<b>Glossy white</b>
<b>Model variation</b>	Two model (Pulling code and wall switch type)
<b>Supply air distribution</b>	<b>Adjustable SA Louvers</b> to Reduce cold draft
<b>Filter</b>	<b>Filter</b> in OA and RA side (Was SA only)
<b>OA High efficiency Filter</b>	Installed : <b>G3 filter</b> 、 Option parts <b>F7 filter</b>
<b>More Wider wall thickness</b>	<b>550 mm</b> pipes enclose (was 300 mm)
<b>Power supply code (Pull SW model)</b>	Power supply code 3m enclose (Was 1 m)

# 2 different model

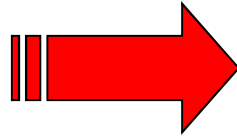

## Pull SW model

## Wall SW model

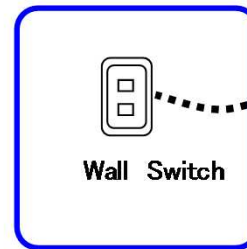
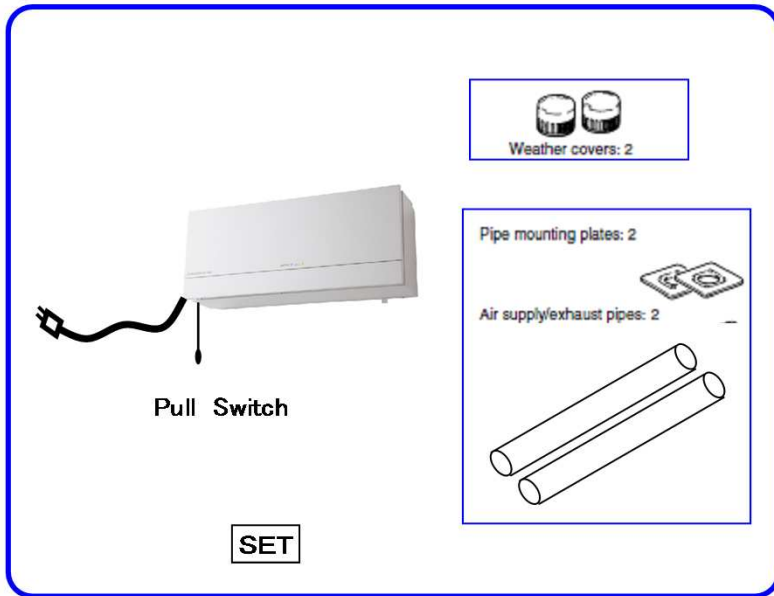

**\* Local purchase**

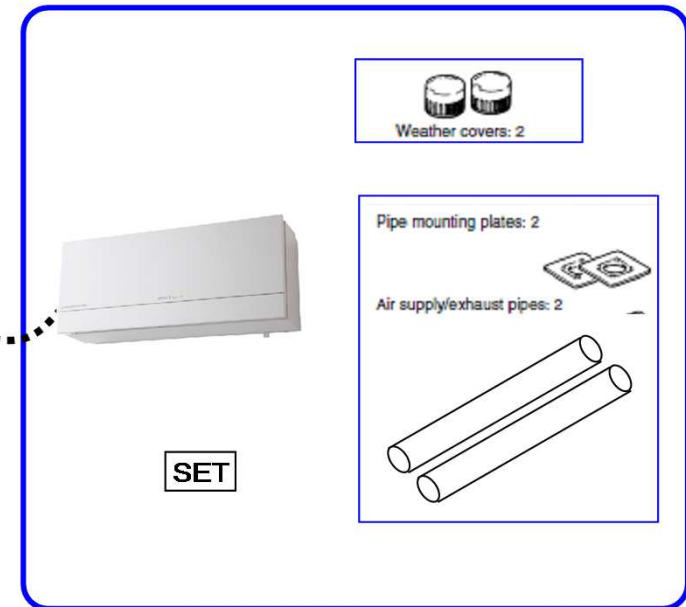

## Specification European model (tentative)

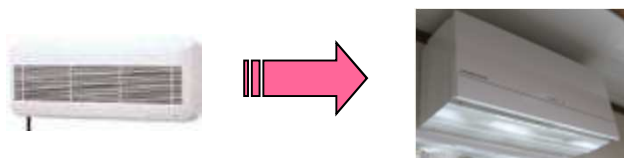

**Current Model  
VL-100U-E  
(Hi/Lo)**



**New Model  
VL-100U5-E  
VL-100EU5-E  
(Hi/Lo)**



<b>Dimension (W-H-D) (mm)</b>	<b>620-265-168</b>	<b>620-265-200</b>
<b>Air volume (m3/Hr)</b>	<b>105 / 65</b>	<b>105 / 60</b>
<b>Temperature Exchange Efficiency(%)</b>	<b>70 / 77</b>	<b>73 / 80</b>
<b>Noise (dB)</b>	<b>39 / 29.5</b>	<b>37 / 25</b>
<b>Power consumption (W)</b>	<b>26 / 23</b>	<b>31 / 15</b>

**ExWorks: June end - Melnak (Japan)**

<Close>



<Open>



**Adjustable Louvers to reduce cold draft (manual)**

## Pull SW model

For easy installation all in one (Same as current model)

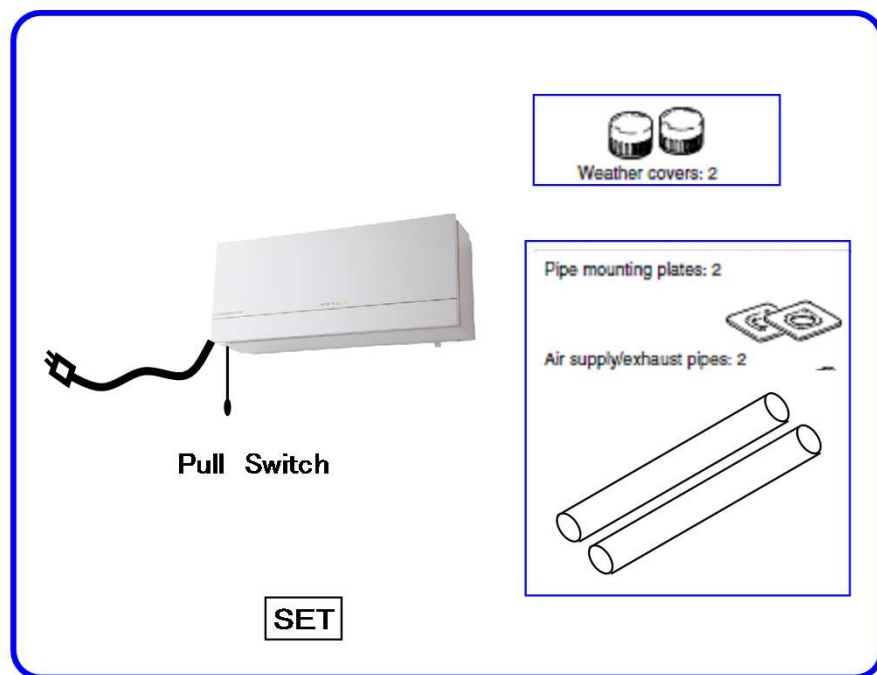

1. Flat Panel Design (like ZEN)  
H200-W620-D265
2. Pull switch (2 fan speed )
3. With 3m long Power supply code  
(was 1m)
4. Pipe
  - 1) length over 550mm(was 300).
  - 2)Extension pipe as optional  
parts300mm(same as current).
5. Weather cover included.

## Wall SW model

1. Flat Panel Design (like ZEN)  
H200-W620-D265
2. Wall switch (2 fan speed )  
\*Local purchase
3. Terminal bed for power supply installation.
4. Pipe  
length over 550mm(was 300)
5. Weather cover included

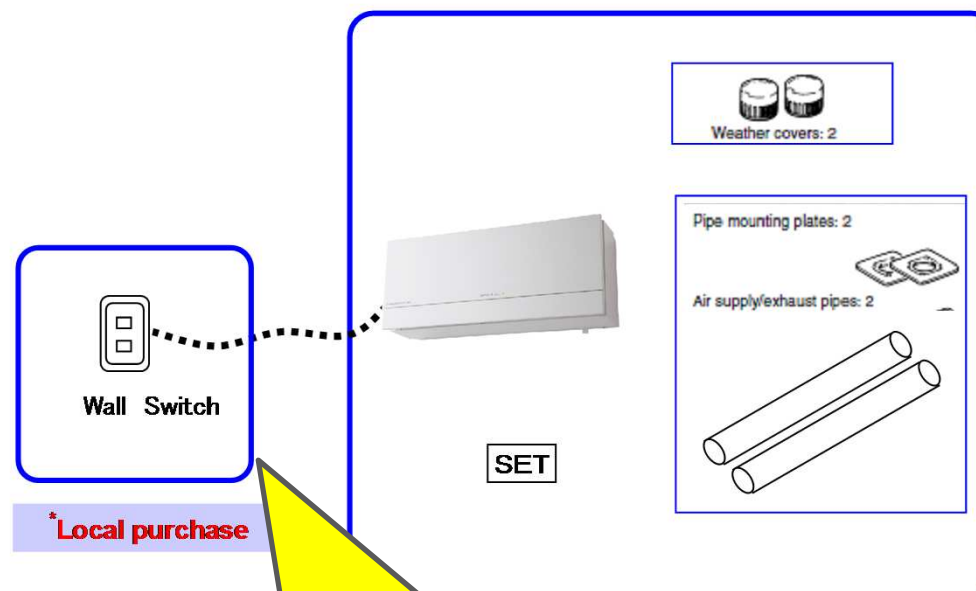

**Possible to connect  
other local control  
(via relè) such as:**

- BMS
- CO<sub>2</sub> sensor
- etc.

### Application:

Residence, Apartment require well designed ventilation.